

# COSMION

## IONTOPHORETIC REJUVENATING FACIAL MASK

INSTRUCTIONS FOR USE OF  
COSMION IONTOPHORETIC REJUVENATING FACIAL MASK

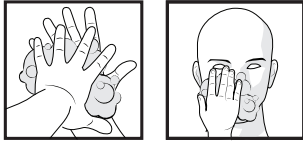

### FACIAL CLEANSING:

- 1 Wash hands with antibacterial soap and water.
  - 2 Gently cleanse face with Cosmion Facial Cleanser.
- ⚠ *It is very important to remove all makeup and other skin products from the skin surface before using the Cosmion Iontophoretic Rejuvenating Mask. This will ensure maximum desired results.*
- 3 Rinse face with clean water and blot dry.

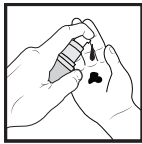

### APPLICATION OF COSMION SERUM (COSMION C IONTOPHORETIC REJUVENATING SERUM OR OTHER COSMION IONTOPHORETIC SERUM):

- ⚠ *Do not use the Cosmion Iontophoretic Rejuvenating Mask with any products other than those furnished by Cosmion. Iontophoresis actively delivers products into the skin. Cosmion products are preservative-free, nutritional-type products that are safe for deep-skin application. Other products may have preservatives and chemicals that should not be used in conjunction with the Cosmion Mask.*
- 4 Apply 3 to 6 pumps of Cosmion Iontophoretic Serum into the palm of one hand. Using 2 or 3 finger tips, spread a visible layer of serum over the entire face, including the lower eyelids and the area of the neck where the patch will be applied (see illustration). Avoid contact with eyes. In case of contact with eyes, rinse immediately with clean, cool water.



### APPLICATION OF THE COSMION IONTOPHORETIC REJUVENATING MASK:

- ⚠ *Do not allow the mask to come into contact with metal objects on the skin such as earrings, nose rings, etc. If you have metal braces or a large number of metal fillings in your teeth, you may experience a heightened tingling sensation in the skin overlying those areas.*

- 5 Open Cosmion Iontophoretic Rejuvenating Mask box and remove foil pouch.
- 6 Open foil pouch and remove Cosmion Mask.

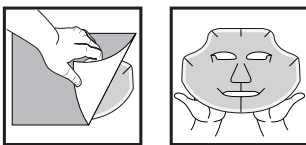

- 7 Lay mask on a clean, flat surface with Cosmion label facing down.
- 8 Remove backing from facial portion of mask only; do not yet remove backing from neck patch. Lay mask on a clean, dry surface, sticky side facing up.
- 9 Using two hands, pick up the mask by the top, disturbing the sticky gel as little as possible.

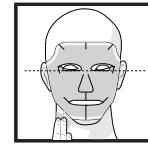

- 10 Using a wall-mounted mirror, look through the eye openings of the mask and align so that the lower edges of the eye openings are immediately under the lower eyelid lashes.
- 11 Apply and smooth the mask over forehead, temples and then the nose. The slits in the mask may be overlapped to achieve a snug fit.
- 12 Apply mask to cheeks and jaw line. Overlap the flaps above and below the lips to achieve a snug fit. Press mask firmly against face, nose, cheeks and chin to achieve complete contact with the skin.
- 13 Be certain that Cosmion Rejuvenating Serum has been applied to the neck where neck patch will be applied.
- 14 Remove backing from the neck patch and apply to neck. Hold in place for a few seconds until patch is firmly adhered.

⚠ *It is important that the neck patch gel surface never come into contact with the gel surface of the face mask. Contact between gel surfaces will short the battery and render the mask ineffective.*

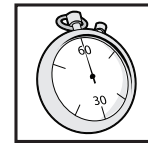

- 15 Recommended length of treatment is 30-60 minutes. It is recommended that you relax and enjoy the mask with soft music, dim lighting and a reclining chair. You may experience a metallic taste or slight tingling as the rejuvenating serum enters your skin. Both are normal, expected sensations with mask use.

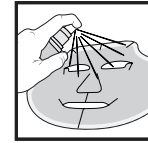

### REMOVING AND STORING MASK:

- 16 After recommended length of use, remove neck patch and reapply paper backing to neck patch to prevent contact with face mask.
- 17 Remove face mask and lay it sticky side up on a clean, dry surface.
- 18 Remove backing from neck patch. Spray sticky side of mask and neck patch with Cosmion Sterilizing Solution.

*Note: Skin will appear well hydrated, softer and smoother after removing mask. Slight swelling and redness may occur, which is normal.*

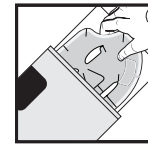

- 19 Allow mask to dry for one minute, then reapply paper backing to mask and neck patch.
- 20 Fold neck patch over mask, reinsert mask into foil pouch and store in a cool, dry location. If cared for as instructed, mask may be reused as often as every other day for up to six separate applications. *(Note: Do not use the mask beyond one month after opening. Safely discard the mask, which contains small batteries.)*



- 21 Rinse face with clean water and apply daily skin care and sunscreen. *Note: Visit cosmion.com for a list of recommended compatible daily-use skin care products.*

Discard after 4 weeks or 6 uses.  
To reorder or for more information, visit [cosmion.com](http://cosmion.com)